

# Fluid control valve(2/2way)

## 2W Series (Direct-acting and normally closed)



2W

### Symbol



### Product feature

1. Direct acting and normally closed type 2/2 way solenoid valve. Its high sensibility allows it to change direction quickly;
2. It has wide pressure range, including extra high pressure (X), high pressure (H), standard, large volume(L) and extra large volume (T) to choose from;
3. It is compact, small size and light weight. It is easy to install and dismantle.
4. The valve body is made of brass. Its coil has a Heat resistance classification of Class B. The standard seal material is FPM-F. Please contact us if other material are required.
5. The protection class of the coil is IP65 and there is a choice for grommet or terminal electrical entry.

### Valve's specification

Acting	Direct acting			
Initial stats	Normally closed			
Adaptable fluid ①	Air, Water, Oil			
Viscosity limit	Under 20CST			
Ambient and fluid temperature(°C)	Water	Air	Oil	Ambient
	Max. 80	90	80	70
	Min. 1	-20 ②	-10 ③	-20

- ① Note: Please refer to P125 for detail of other's fluid.  
 ② Note: Dew point: -20(°C) or less. ③ Note: 50CST or less.

### Inner structure

2W030(Terminal)

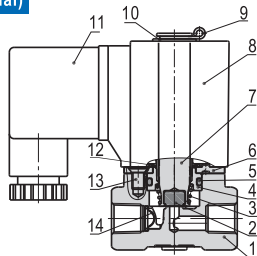

No.	Item	No.	Item	No.	Item
1	Body	6	Fixed plate	11	Connector
2	Airtight ring	7	Movable core	12	Washer
3	Spring	8	Coil assembly	13	Screw
4	Fixed cap	9	E Clip	14	Filter
5	O-ring	10	Gasket		

① Extra large volume type has no filter element.

### Specification

Type\Item	Port size①	Orifice size (Φ mm)	Cv	Valid area or section(mm²)	Weight ② (g)	Max. operating pressure differentia		Proof pressure	
						MPa	psi	MPa	psi
2WX030	-06 1/8"	1.5	0.10	1.8	305	3.0	450	5.0	750
	-08 1/4"				295				
2WH030	-06 1/8"	2.0	0.18	3.0	305	2.0	300		
	-08 1/4"				295				
2W030	-06 1/8"	3.0	0.33	6.0	305	1.0	150		
	-08 1/4"				295				
2WL030	-06 1/8"	4.0	0.55	10.0	305	0.5	75		
	-08 1/4"				295				
2WT030	-06 1/8"	6.0	1.10	12.0	305	0.1	15		
	-08 1/4"				295				
2WX050	-10 3/8"	3.0	0.34	6.1	620	3.0	450		
	-15 1/2"				600				
2WH050	-10 3/8"	4.0	0.55	10.0	620	2.0	300		
	-15 1/2"				600				
2W050	-10 3/8"	5.0	0.83	15.0	620	1.0	150		
	-15 1/2"				600				
2WL050	-10 3/8"	7.0	1.40	25.0	620	0.5	75		
	-15 1/2"				600				
2WT050	-10 3/8"	10.0	2.20	40.0	620	0.1	15		
	-15 1/2"				600				

- ① PT thread, NPT thread and G thread are available.  
 ② The weight in the table is the terminal valve's weight, 2W030 series grommet valve's weight is 10g less than terminal's. 2W050series grommet valve's weight is 20g less than terminal's.

### Specification of coil

Valve type	Coil type	Power type	Frequency (Hz)	Voltage range	Electrical entry	Power Consumption (VA/W)	Insulation	Temp. rise(°C)
2W□030	CDA116 CLA116	AC	50	± 15%	Terminal (CDA) Grommet (CLA)	10.0VA	Class B	35
			60			8.0VA		30
		DC	-	± 10%		6.5W		30
2W□050	CDA170 CLA170	AC	50	± 15%		25.0VA		60
			60			22.0VA		55
		DC	-	± 10%		10.5W		40

### Ordering code

**2W L 030 08 A □ P**

- Model**: 2W: 2/2 way direct-acting and normally closed
- Pressure condition**: X: Extra high pressure, H: High pressure, Blank: Standard, L: Large volume, T: Extra large volume
- Size series**: 030: 030 Series, 050: 050 Series
- Port size**: 030 Series: 06: 1/8", 08: 1/4"; 050 Series: 10: 3/8", 15: 1/2"
- Thread type**: P: PT, T: NPT, G: G
- Electrical entry**: Blank: Terminal, I: Grommet
- Voltage**: A: AC220V, B: DC24V, C: AC110V, E: AC24V, F: DC12V

### Ordering code of accessories

Ordering code of accessories is the same as 2S series valve's, Please refer to P100 for details of ordering code.



# Fluid control valve(2/2way)

## 2W Series (Direct-acting and normally closed)



### Flow chart

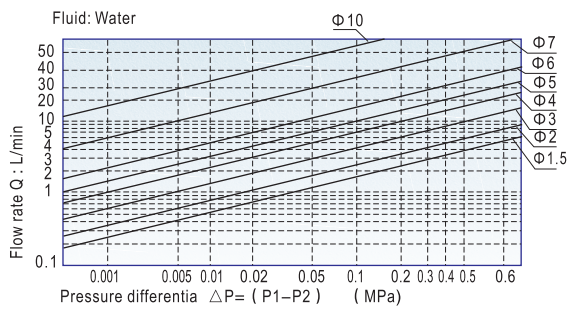
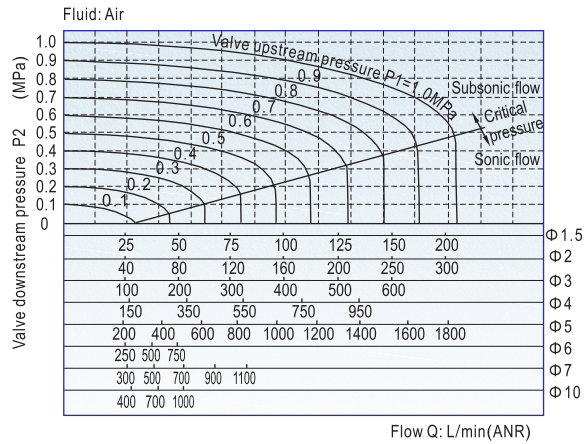

### Dimensions

#### 2W□030(Terminal)

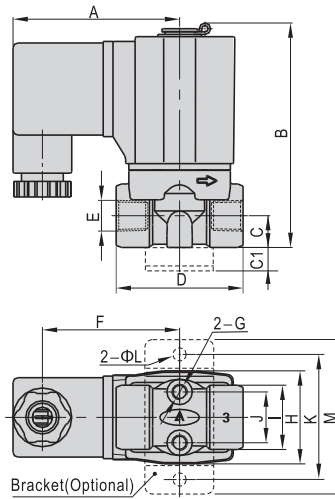

#### 2W□050(Terminal)

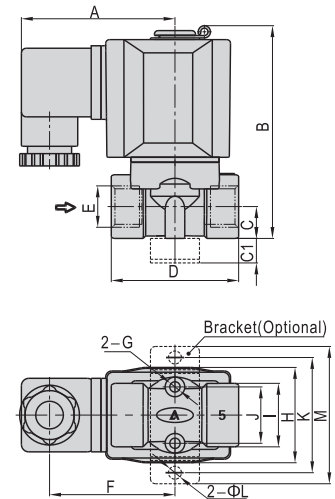

Type\Item	A	B	C	C1	D	E	F	G	H	I	J	K	L	M
2W□030-06	52.5	70.7	10	10	40	1/8"	43.3	M5	29.3	20.2	16	40	5.3	49
2W□030-08	52.5	70.7	10	10	40	1/4"	43.3	M5	29.3	20.2	16	40	5.3	49
2W□050-10	62.7	87	13	10	52	3/8"	51.2	M5	39	26	23	48	5.3	56
2W□050-15	62.7	87	13	10	52	1/2"	51.2	M5	39	26	23	48	5.3	56

#### 2W□030(Grommet)

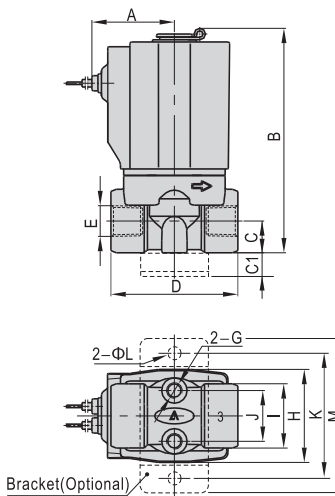

#### 2W□050(Grommet)

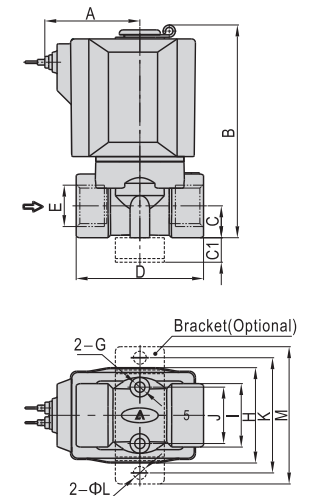

Type\Item	A	B	C	C1	D	E	G	H	I	J	K	L	M
2W□030-06	26	70.7	10	10	40	1/8"	M5	29.3	20.2	16	40	5.3	49
2W□030-08	26	70.7	10	10	40	1/4"	M5	29.3	20.2	16	40	5.3	49
2W□050-10	39	87	13	10	52	3/8"	M5	39	26	23	48	5.3	56
2W□050-15	39	87	13	10	52	1/2"	M5	39	26	23	48	5.3	56



2W

# Fluid control valve(2/2way)



## 2W Series (Internally piloted and normally closed)



2W

### Symbol



### Product feature

1. Indirect acting (Internal pilot) and normally closed type 2/2 way solenoid valve. Its can change direction quickly and has large flow.
2. It is compact, small and light weight. It is easy to install and dismantle;
3. The valve body is made of brass. The coil has a Heat resistance classification of Class B. The standard seal material is FPM-F. Please contact us if other material are required.
4. The protection class of the coil is IP65 and there is a choice for grommet or terminal electrical entry.

### Valve's specification

Acting	Internally piloted			
Initial stats	Normally closed			
Adaptable fluid ①	Air, Water, Oil			
Viscosity limit	Under 20CST			
Ambient and fluid temperature(°C)	Water	Air	Oil	Ambient
	Max. 80	90	80	70
	Min. 1	-20 ②	-10 ③	-20

① Note: Please refer to P125 for detail of other's fluid.

② Note: Dew point: -20(°C) or less. ③ Note: 50CST or less.

### Inner structure

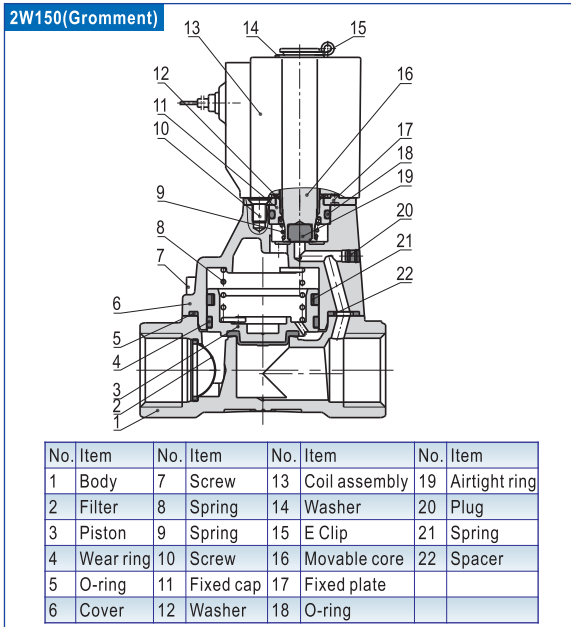

### Specification

Type\Item	Port size ①	Orifice size (Φmm)	Cv	Valid area or section(mm²)	Weight ② (g)	Max.operating pressure differentia		Proof pressure	
						MPa	psi	MPa	psi
2W150-15	1/2"	15.0	5.50	100.0	720	Max:1.0 Min:0.05	Max:150 Min:10	1.5	220
2W200-20	3/4"	20.0	9.50	170.0	950				
2W250-25	1"	25.0	12.50	220.0	1200				

① PT thread, NPT thread and G thread are available.

② The weight in the table is the terminal valve's weight, grommet valve's weight is 10g less than terminal's.

### Specification of coil

Valve type	Coil type	Power type	Frequency (Hz)	Voltage range	Electrical entry	Power Consumption (VA/W)	Insulation	Temp. rise(°C)
2W150	CDA116	AC	50	± 15%	Terminal (CDA)	10.0VA	Class B	35
2W200			60			8.0VA		30
2W250	DC	-	± 10%	Grommet (CLA)	6.5W	30		

### Ordering code

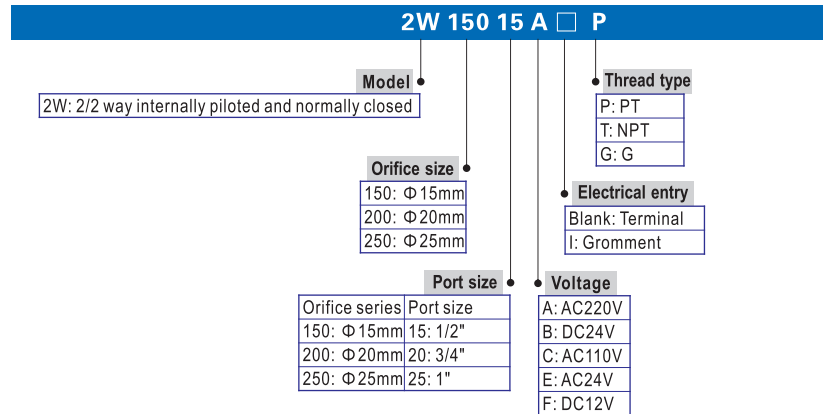

### Ordering code of accessories

Ordering code of accessories is the same as 2S series valve's, Please refer to P102 for details of ordering code.



# Fluid control valve(2/2way)

## 2W Series ( Internally piloted and normally closed)



### Flow chart

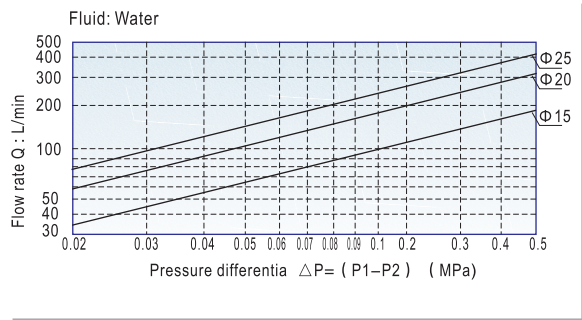
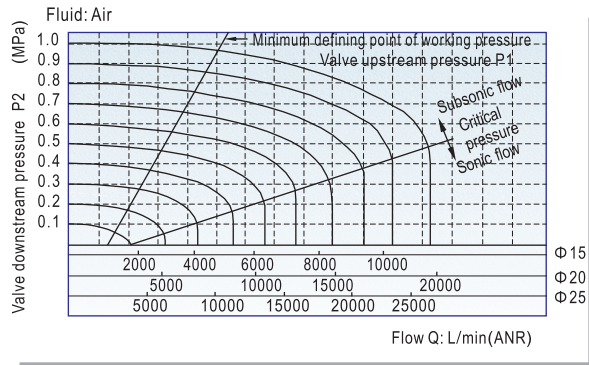

### Dimensions

#### Terminal

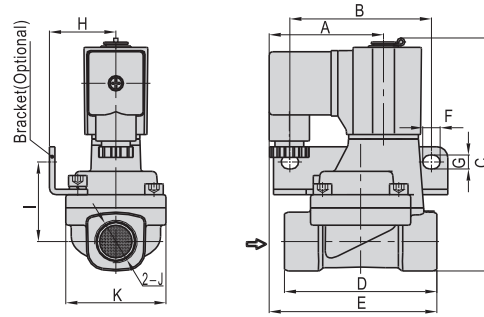

Type\Item	A	B	C	D	E	F	G	H	I	J	K
2W150-15	52.5	65	107	70	77	8	6.4	30.5	36.5	1/2"	46
2W200-20	52.5	75	115.4	82	78.5	8	6.4	34	40	3/4"	53
2W250-25	52.5	80	124	92	81	8	6.4	36	44.5	1"	59

#### Grommet

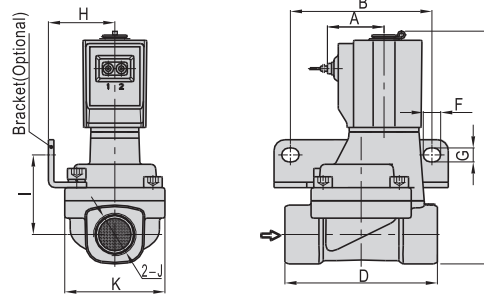

Type\Item	A	B	C	D	F	G	H	I	J	K
2W150-15	26	65	107	70	8	6.4	30.5	36.5	1/2"	46
2W200-20	26	75	115.4	82	8	6.4	34	40	3/4"	53
2W250-25	26	80	124	92	8	6.4	36	44.5	1"	59



2W